

HARDLINE CONNECTORS

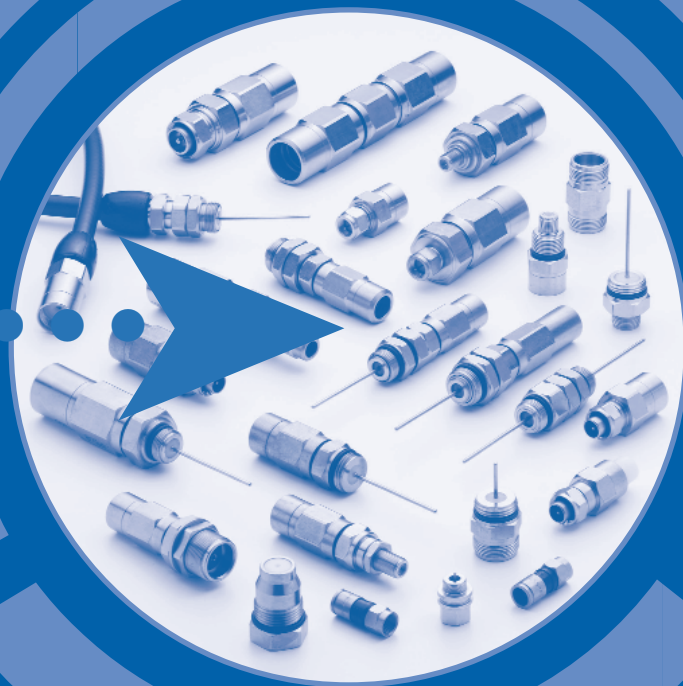

HARDLINE CONNECTORS



FEATURES

- Return loss better than -30dB to 1GHz.
- At extreme temperatures (-40 to $+85$ degree C) high RF integrity maintained, with shielding effectiveness better than -110dB .
- All PPC Denmark products are plated with the unique NITIN plating for the highest protection against corrosion and attack from environmental pollution.
- Connector Holding Power maintained over the full temperature range, without damage to cable.
- Connectors have patented Anti-Rotational feature, which prevents cable from twisting as the back nut is tightened.
- Connectors are re-usable.
- Positive stop feature eliminates need for torque wrenches or special tools.
- Installation always consistent – Connector cannot be over tightened to damage cable.
- Only one wrench size needed for each connector.
- Physical contour easy to handle, allowing for simplified installation of heat shrink tubing, where used.
- Standard PPC Line accommodates cable and equipments of all past and current American and European CATV manufacturers.
- Each connector individually stamped to identify Connector size and type.
- 47 mm/1.85" pins are standard on all PPC 5/8male and PG11male Connectors and Adaptors. Other lengths available on request.
- PPC has an Inner- and Outer Conductor Length Cut Mark placed on the back nut of all Connectors to identify correct Cut Length.
- All F female Connectors and Adaptors with high quality 4 finger Inner Conductor allowing 4 Amp current.

PPC Denmark

Vaerkstedsvej 14
DK-4720 Praestoe
Denmark
Telephone: +45 55 99 17 22
Fax: +45 55 99 27 22
E-mail: ppc@ppc.dk
Web: www.ppc.dk

PPC

6176 East Molloy Road
East Syracuse · New York 13057-0278
USA
Telephone: +1 315 431 7200
Fax: +1 315 431 7201
E-mail: ppc@ppc-online.com
Web: www.ppc-online.com

HARDLINE CONNECTORS



PPC DENMARK HARDLINE CONNECTOR PART IDENTIFICATION

Physical size of the Connector:

A	Hex size 14 =	Cable size 6,0 - 8,0 mm.
B	Hex size 18 =	Cable size 9,0 - 11,5 mm.
D	Hex size 20 =	Cable size 11,5 - 13,5 mm.
E	Hex size 22 =	Cable size 13,5 - 16,0 mm.
G	Hex size 25 =	Cable size 16,0 - 18,5 mm.
H	Hex size 27 =	Cable size 18,5 - 22,0 mm.
M	Hex size 32 =	Cable size 23,0 - 25,5 mm.
R	Hex size 38 =	Cable size 27,0 - 31,0 mm.
S	Hex size 42 =	Cable size 32,0 - 35,0 mm.

PPC Part Number Identification: (example)

Letter code for hex size of Connector

Cable size in mm

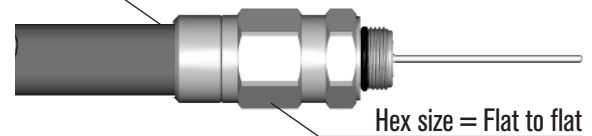

B004-5/8m

2nd- 4th digits. Connector code

e.g. 004 referring to our cross reference

list of the cable manufacture. (see cable pages)

Port e.g. 5/8m

PPC description	Detailed description	PPC Description	Detailed description
5/8m	5/8 male	PG13,5m	PG13,5 male
5/8ms	5/8 male, swivel	PG13,5ms	PG13,5 male, swivel
5/8f	5/8 female	PG13,5ft	PG13,5 feed true
5/8fs	5/8 female, swivel	IECm	IEC14 male
5/8-Ff	5/8 tread w. F female	IECf	IEC14 female
5/8ft	5/8 feed true	3,5/12m	3,5/12 male
5/8fts	5/8 feed thru w. swivel	3,5/12f	3,5/12 female
PG11m	PG11 male	Fm	F male
PG11ms	PG11 male, swivel	Ff	F female
PG11f	PG11 female	M181x1	18mm metric
PG11fs	PG11 female, swivel	Nm	N male
PG11/Ff	PG11 thread w/F female	Nf	N female
PG11ft	PG11 feed thru	SPL	Splice
PG11fts	PG11 feed thru w. swivel	SPR	Splice reducer

PPC Denmark

Vaerkstedsvej 14
DK-4720 Praestoe
Denmark

Telephone: +45 55 99 17 22
Fax: +45 55 99 27 22
E-mail: ppc@ppc.dk
Web: www.ppc.dk

PPC

6176 East Molloy Road
East Syracuse · New York 13057-0278
USA

Telephone: +1 315 431 7200
Fax: +1 315 431 7201
E-mail: ppc@ppc-online.com
Web: www.ppc-online.com

HARDLINE CONNECTORS



TYPICAL EXAMPLE OF DATA SHEET

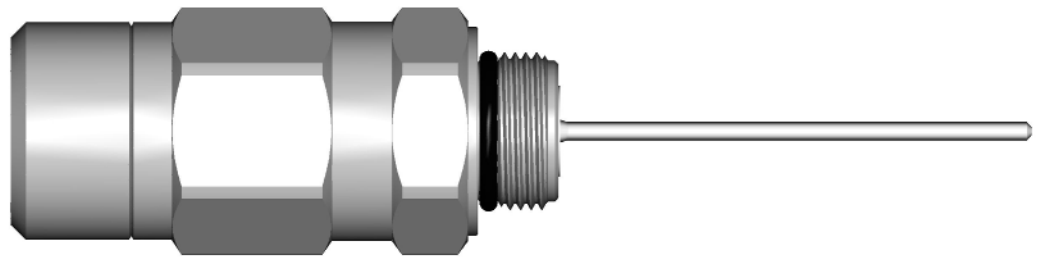

No.	30220150
Connector Type:	E019 - 5/8m 47mm

Band Width:	5 MHz - 2.2GHz
Impedance:	75 Ohm
Amp. Rating:	15 A
Shielding:	>110dB @ 900 MHz

Temperature	
Installing:	-5 to +50 °C
Operating:	-40 to +85 °C
Sealing Test:	DS / IEC 529: IP X7

Return Loss: @ MHz, Better Than	
500:	-36 dB
860:	-33 dB
1000:	-32 dB
1750:	-32 dB

Insertion Loss: @ MHz, Better Than	
500:	-0,05 dB
860:	-0,06 dB
1000:	-0,07 dB
1750:	-0,08 dB

Pull Strength:	
Total:	142 kg
Inner Conductor:	20 kg
Jacket:	142 kg

Dielectric Strength:	3 kV
Insulation Resistance:	(@500V): >29.99Gohm
Inner Conductor:	Resistance max. @ 1A DC: 0.5 mOhm

Material and Plating		
Body:	Brass	NiSn (NiTin)
Inner Cond.	Brass	NiSn (NiTin)
O'rings	EPDM	
Insulators	Polycarbonat / Polyethylene	

PPC Denmark

Vaerkstedsvej 14
DK-4720 Praestoe
Denmark
Telephone: +45 55 99 17 22
Fax: +45 55 99 27 22
E-mail: ppc@ppc.dk
Web: www.ppc.dk

PPC

6176 East Molloy Road
East Syracuse · New York 13057-0278
USA
Telephone: +1 315 431 7200
Fax: +1 315 431 7201
E-mail: ppc@ppc-online.com
Web: www.ppc-online.com

HARDLINE CONNECTORS



TYPICAL EXAMPLE OF INSTALLATION INSTRUCTION

Connector: 30220150 E019 - 5/8m

Cable: COAX-4

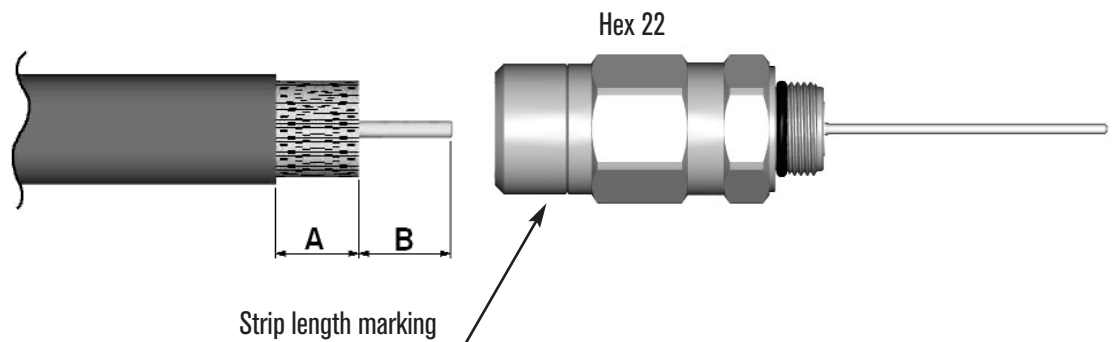

From the end of the cable measure back 12mm for Hex 22. At this point, cut cleanly and directly through to the center conductor and remove cable to expose center conductor, measurement "B" 12mm.

From here, the point where the center conductor exits the cable, measure back another 12mm, measurement "A". Carefully cut directly and cleanly through the sheath (jacket) until the copper braid is reached and pull of the sheath, exposing the braid and tape (foil).

For assistance, on the back lock nut shell of the connector, a groove has been added which represent measurements "A" and "B". Use this for measuring against the cable for correct preparation.

Measure and trim the pin (stinger) of the Connector Body according to the equipment manufacturer specification. Then insert the pin into the equipment and thread the Connector Body "C" into the equipment until hand tight, then fully wrench tighten, using 20-22 Nm / 15-17 ft. Pound. (1/4 turn).

Slide the back nut of the connector over the cable until it bottoms out / positive stop. - While holding the cable and the back nut, insert/push the center conductor into the connector body.

Hand tighten the back nut fully onto the connector body, while holding the cable and the back nut. Wrench tighten the back nut until the lead edge of the back nut bottoms against the shoulder of the connector body - metal to metal / positive stop "B".

THIS IS MOST IMPORTANT TO ENSURE CORRECT COMPRESSION IS ACHIEVED.

Recommended stripping tool: 90700500 - E019 Prep. Tool

PPC Denmark

Vaerkstedsvej 14
DK-4720 Praestoe
Denmark
Telephone: +45 55 99 17 22
Fax: +45 55 99 27 22
E-mail: ppc@ppc.dk
Web: www.ppc.dk

PPC

6176 East Molloy Road
East Syracuse · New York 13057-0278
USA
Telephone: +1 315 431 7200
Fax: +1 315 431 7201
E-mail: ppc@ppc-online.com
Web: www.ppc-online.com

HARDLINE CONNECTORS



HARDLINE CONNECTORS

5/8m

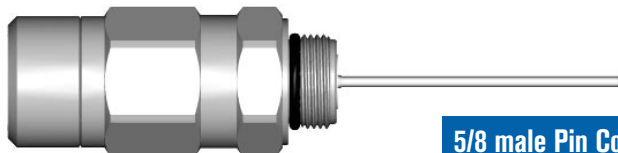

5/8 male Pin Connector

5/8 x 24 UNEF thread according to SCTE-IPS-SP-403

Pin diameter \varnothing 1,8mm/0,071"

Standard Pin length 47mm. Other Pin lengths on request

PG11m

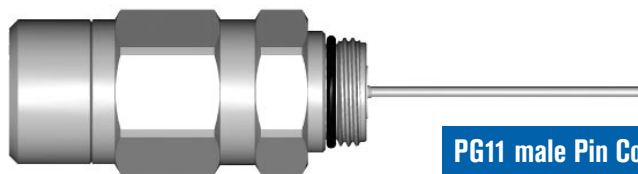

PG11 male Pin Connector

PG11 thread (1,41)

Pin diameter \varnothing 1,8mm/0,071"

Standard Pin length 47mm. Other Pin lengths on request

5/8ms

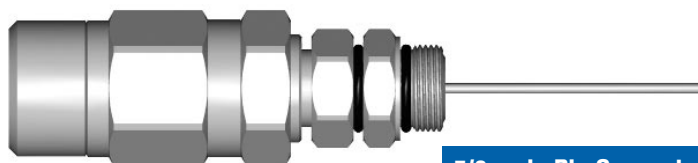

5/8 male Pin Connector with Swivel Nut

5/8 x 24 UNEF thread according to SCTE-IPS-SP-403

Pin diameter \varnothing 1,8mm/0,071"

Standard Pin length 47mm. Other Pin length on request

PG11ms

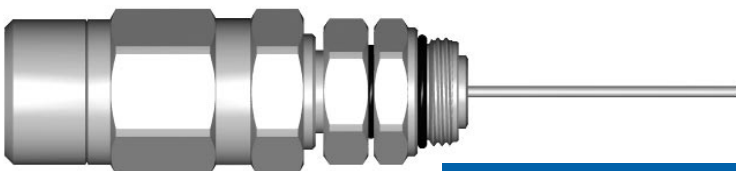

PG11 male Pin Connector with Swivel Nut

PG11 thread (1,41)

Pin diameter \varnothing 1,8mm/0,071"

Standard Pin length 47mm. Other pin lengths on request

PPC Denmark

Vaerkstedsvej 14
DK-4720 Praestoe
Denmark

Telephone: +45 55 99 17 22
Fax: +45 55 99 27 22
E-mail: ppc@ppc.dk
Web: www.ppc.dk

PPC

6176 East Molloy Road
East Syracuse · New York 13057-0278
USA

Telephone: +1 315 431 7200
Fax: +1 315 431 7201
E-mail: ppc@ppc-online.com
Web: www.ppc-online.com

HARDLINE CONNECTORS



HARDLINE CONNECTORS

5/8ft

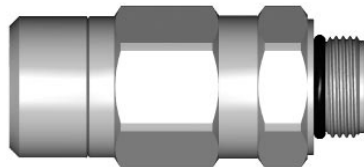

5/8 Feed thru Connector

5/8 x 24 UNEF thread according to SCTE-IPS-SP-403

PG11ft

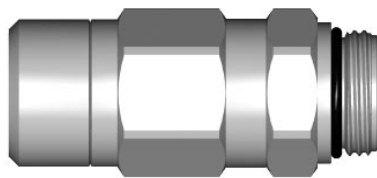

PG11 Feed thru connector

PG11 thread (1,41)

5/8fts

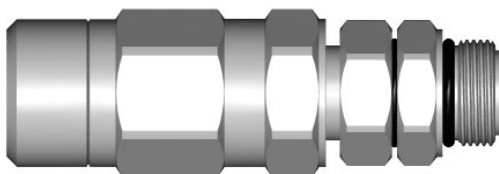

5/8 Feed thru with Swivel Nut

5/8 x 24 UNEF tread according to SCTE-IPS-SP-403

PG11fts

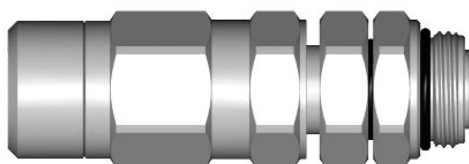

PG11 Feed thru with Swivel Nut

PG11 Thread (1,41)

PPC Denmark

Vaerkstedsvej 14
DK-4720 Praestoe
Denmark

Telephone: +45 55 99 17 22
Fax: +45 55 99 27 22
E-mail: ppc@ppc.dk
Web: www.ppc.dk

PPC

6176 East Molloy Road
East Syracuse · New York 13057-0278
USA

Telephone: +1 315 431 7200
Fax: +1 315 431 7201
E-mail: ppc@ppc-online.com
Web: www.ppc-online.com

HARDLINE CONNECTORS

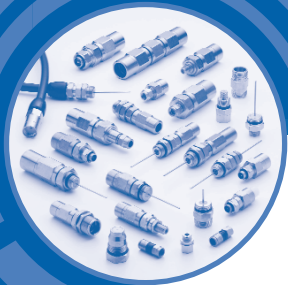

HARDLINE CONNECTORS

3,5/12m



3,5/12 male Connector
Nut = HEX 22mm
According to IEC 169-14

3,5/12f

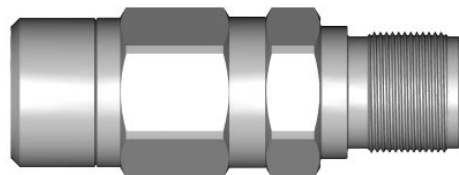

3,5/12 female Connector
According to IEC 169-14

3,5/12f-C

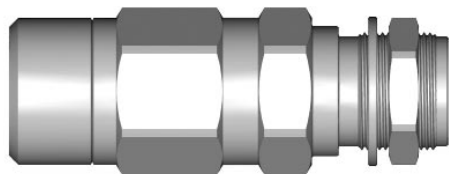

3,5/12 female Connector for Chassis mounting
According to IEC 169-14
Nut = HEX 22mm, Washer \varnothing 25mm

IECm



IEC male Connector
Nut = HEX 15mm
According to IEC 169-2

PPC Denmark

Vaerkstedsvej 14
DK-4720 Praestoe
Denmark

Telephone: +45 55 99 17 22
Fax: +45 55 99 27 22
E-mail: ppc@ppc.dk
Web: www.ppc.dk

PPC

6176 East Molloy Road
East Syracuse · New York 13057-0278
USA

Telephone: +1 315 431 7200
Fax: +1 315 431 7201
E-mail: ppc@ppc-online.com
Web: www.ppc-online.com

HARDLINE CONNECTORS



HARDLINE CONNECTORS

PG11/IECf-C

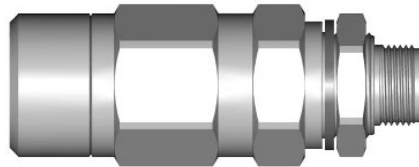

PG11 thread for Chassis mounting with IEC female
IEC standard 169-2
Nut = HEX 22mm, Copper washer \varnothing 22mm

PG11/IECf-C-long

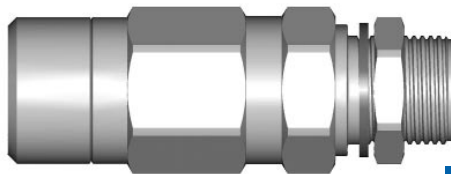

PG11 thread for Chassis mounting with IEC female
push on
IEC standard 169-2
Nut = HEX 22mm, Copper washer \varnothing 22mm

Fm

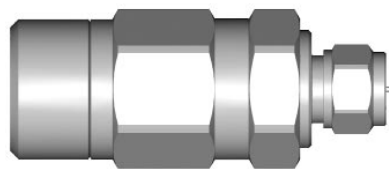

F male Connector
3/8 x 32 UNEF thread according to SCTE-IPS-SP-401
and IEC standard 169-24
Pin diameter \varnothing 0,9mm/0,0355"

Ff



F female Connector
3/8 x 32 UNEF thread according to SCTE-IPS-SP-401
and IEC standard 169-24
Accepts 0,6-1,2mm Pin

PPC Denmark

Vaerkstedsvej 14
DK-4720 Praestoe
Denmark
Telephone: +45 55 99 17 22
Fax: +45 55 99 27 22
E-mail: ppc@ppc.dk
Web: www.ppc.dk

PPC

6176 East Molloy Road
East Syracuse · New York 13057-0278
USA
Telephone: +1 315 431 7200
Fax: +1 315 431 7201
E-mail: ppc@ppc-online.com
Web: www.ppc-online.com

HARDLINE CONNECTORS



HARDLINE CONNECTORS

Ff-C

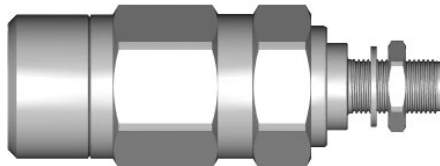

F female Connector for Chassis mounting
3/8 x 32 UNEF thread according to SCTE-IPS-SP-401
and IEC standard 169-24
Accepts 0,6-1,2mm Pin
Nut = HEX 14mm, washer ø 14mm

N male

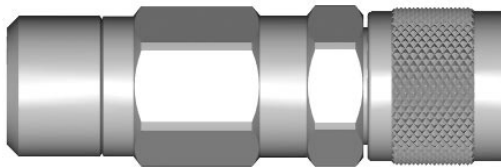

N male Connector
According to IEC standard 169-16

5/8-Ff

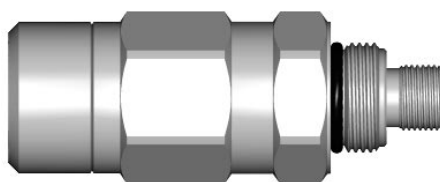

5/8 thread – F female Connector
5/8 x 24 UNEF thread
F female port (3/8 x 32 UNEF) according to IEC 169-24
Accepts 0,6-1,2mm Pin

SPL

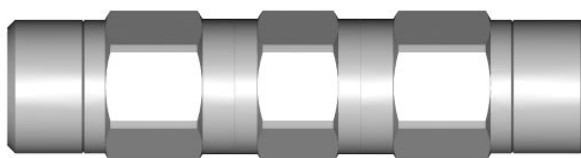

Splice Connector
Connecting two equal cable-ends

PPC Denmark

Vaerkstedsvej 14
 DK-4720 Praestoe
 Denmark

Telephone: +45 55 99 17 22
 Fax: +45 55 99 27 22
 E-mail: ppc@ppc.dk
 Web: www.ppc.dk

PPC

6176 East Molloy Road
 East Syracuse · New York 13057-0278
 USA

Telephone: +1 315 431 7200
 Fax: +1 315 431 7201
 E-mail: ppc@ppc-online.com
 Web: www.ppc-online.com

HARDLINE CONNECTORS



HARDLINE CONNECTORS

SPR

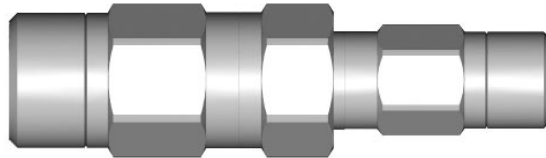

Splice reduce Connector
Connecting two different cable ends

PPC Denmark

Vaerkstedsvej 14
DK-4720 Praestoe
Denmark
Telephone: +45 55 99 17 22
Fax: +45 55 99 27 22
E-mail: ppc@ppc.dk
Web: www.ppc.dk

PPC

6176 East Molloy Road
East Syracuse · New York 13057-0278
USA
Telephone: +1 315 431 7200
Fax: +1 315 431 7201
E-mail: ppc@ppc-online.com
Web: www.ppc-online.com